

TRESPA® METEON® | EXTERIOR

IMAGINE
SPECTACULAR
FAÇADES



Think Trespa

TRESPA®

TRESPA® METEON®

COLOURING THE WORLD

TRESPA INTERNATIONAL B.V. IS A LEADING INNOVATOR IN THE FIELD OF ARCHITECTURAL MATERIALS, RECOGNISED INTERNATIONALLY AS A PREMIER DEVELOPER OF HIGH QUALITY PANELS FOR EXTERIOR CLADDING AND DECORATIVE FAÇADES. SINCE ITS FOUNDING IN 1960, TRESPA HAS WORKED CLOSELY WITH ARCHITECTS, DESIGNERS, INSTALLERS, DISTRIBUTORS AND END USERS GLOBALLY. TRESPA BELIEVES IN PRODUCT INNOVATION, COMBINING QUALITY MANUFACTURING TECHNOLOGIES WITH SMART SOLUTIONS FOR ARCHITECTURAL APPLICATIONS.

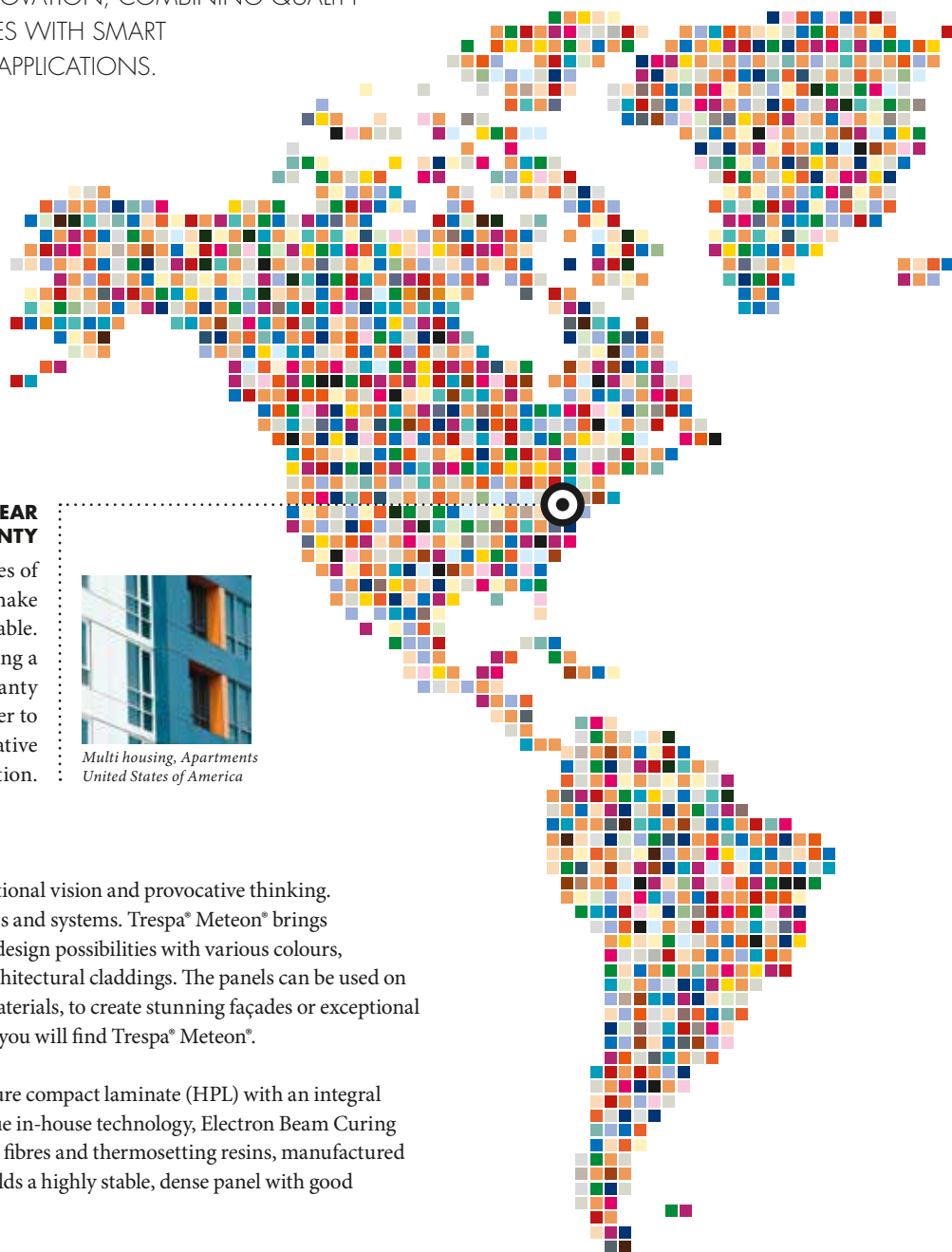

10-YEAR PRODUCT WARRANTY

The unique properties of Trespa® Meteon® panels make them highly durable. That's why Trespa is offering a ten year conditional warranty on its product. Please refer to your local sales representative for more information.



*Multi housing. Apartments
United States of America*

WHERE CONCEPT MEETS SOLUTION

Good design starts with inspiration, exceptional vision and provocative thinking. It comes to life with great materials, finishes and systems. Trespa® Meteon® brings compelling aesthetics and nearly limitless design possibilities with various colours, rhythms and depths to next-generation architectural claddings. The panels can be used on their own, or in combination with other materials, to create stunning façades or exceptional highlights. Where concept meets solution, you will find Trespa® Meteon®.

Trespa® Meteon® is a decorative high-pressure compact laminate (HPL) with an integral surface manufactured using Trespa's unique in-house technology, Electron Beam Curing (EBC). The blend of up to 70% wood-based fibres and thermosetting resins, manufactured under high pressures and temperatures yields a highly stable, dense panel with good strength-to-weight ratios.

Trespa® Meteon® stands out in vertical exterior wall coverings such as façade cladding, balcony panelling, sunblinds as well as horizontal exterior ceiling applications.

Think Trespa

FOR MORE DETAILED INFORMATION PLEASE VISIT TRESPA.COM AND TRESPA.INFO



Public Building | France

COMMITTED TO SAFETY

Trespa is committed to the safety of its processes and products. Two classes of Trespa® Miteon® are available: Standard grade and enhanced Fire-Retardant grade (FR). Please contact your local Trespa representative for local availability.

LOW MAINTENANCE & EASY TO CLEAN

The closed surface of Trespa® Miteon® practically withstands dirt accumulation, keeping the product smooth and easy to clean.

LONG LIFE PERFORMANCE

Trespa® Miteon® is ideal for prolonged exposure as it stays looking great for many years and needs little maintenance.

Trespa® Miteon® remains the material of choice for architects today, because they can be sure that it will still define the urban landscape tomorrow.



Education | China

SOLID & STURDY

Consistent and high-density throughout, Trespa® Miteon® holds screws and other mechanical fixings solidly. The panels have good compressive and tensile strength and excellent pullout and impact resistance, yet Trespa® Miteon® is easily machinable and workable like hardwood.

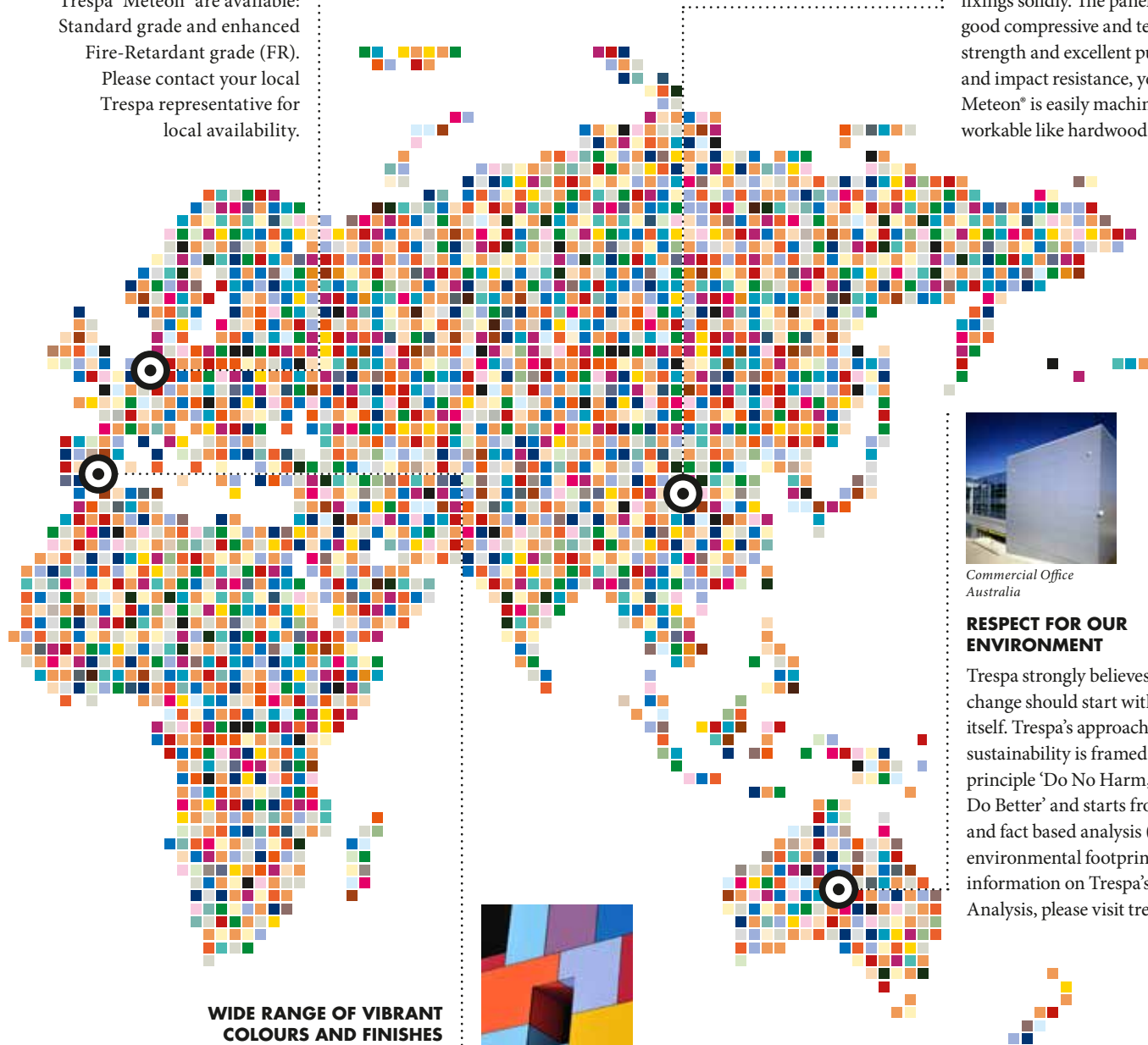

WIDE RANGE OF VIBRANT COLOURS AND FINISHES

Trespa® Miteon® is at the forefront of attractive design and architecture.

The product is available in many standard colours and finishes and even custom-made project colours.

The acclaimed Naturals and Wood Decors collections offer a wide range of wood grains and organic motifs.



Leisure, Cultural, Sports Spain

WEATHER RESISTANT & COLOUR STABILITY

Trespa® Miteon® performs exceptionally well outdoors. Sun and rain will have no significant effect on the panel's surface.



Commercial Office Australia

RESPECT FOR OUR ENVIRONMENT

Trespa strongly believes that any change should start with the company itself. Trespa's approach towards sustainability is framed by the principle 'Do No Harm, Do Good, Do Better' and starts from an objective and fact based analysis (LCA) of its environmental footprint. For more information on Trespa's Life Cycle Analysis, please visit trespa.com.

TRESPA®

VENTILATED FAÇADES

Trespa® Meteon® panels are perfect for use in innovative and functional ventilated façade systems. Used on its own or as a highlight in combination with other materials, Trespa® Meteon® determines the look and underlines the qualities of a building.

Trespa is at the forefront of cutting-edge building techniques. Ventilating façades are more than a design gesture - they may provide energy efficient, long-lasting properties.

ADVANTAGES OF VENTILATED FAÇADE SYSTEMS

- A continuous airflow draws air through the cavity, aiding in the removal of heat and moisture from rain or condensation.
- The rainscreen also blocks parts of the solar radiation and accommodates continuous insulation, which may improve the overall energy performance of the building.
- Residents and users not only find themselves in a low-maintenance-environment, but the dry and comfortable conditions of the building may also have a positive contribution to the indoor environment.

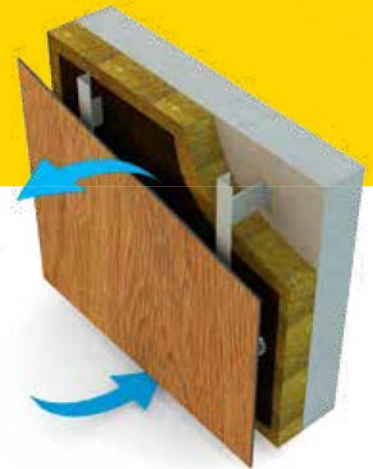

STRONG FOCUS ON SERVICE

As specialist in exterior cladding, Trespa provides knowledge and technical information to aid the design and construction of panelled façades. During all phases of a project, from design and specification to installation, Trespa has a strong focus on service and can provide answers and information to support customers.

Trespa is fully aware that architects wish to realise their specific design going beyond standard solutions. Many customised façades can be realised by offering specific services, especially where Trespa is involved in the early design stage, to give customers detailed advice.



SOLUTION PROVIDING AND VALUE ADDING SERVICES

■ PRODUCT TRAINING SESSIONS

Trespa provides training sessions for both installers and designers on topics such as the ventilated façade concept and installation, and product properties and features.

■ TECHNICAL SUPPORT

Trespa can guide its partners to achieve optimal technical solutions with appropriate fixing systems.

■ INSTRUCTIONS FOR PANEL HANDLING AND MACHINING

High aesthetical quality requires craftsmanship, the right tools and equipment. Trespa will gladly provide advice on these areas.

■ DESIGN SUPPORT

Trespa Studio, a multidisciplinary group working on innovative solutions, supporting architects in façade design and offering a special “graphics on façades” service (only available for selected

countries), that creates unique images with a random repeat (patent pending).

■ DESIGN CENTRES

Trespa Design Centres are based in New York, Barcelona, Santiago de Chile and Weert (the Netherlands). These are unique collaborative spaces inspiring architects, installers and clients. These Centres offer conferences and seminars that facilitate meaningful dialogues with Trespa's partners.

■ INTERNATIONAL CUSTOMER SUPPORT SERVICE

Trespa Customer Service Desk is available throughout all the regions in which the company is active.

■ CUSTOM MADE SOLUTIONS

Through intensive dialogue with architects and by offering Trespa's customized colours (for projects over 200m² (~ 2,153 ft²)), Trespa has contributed to the realisation of many unique façade designs. These bespoke façade designs are not only beautiful, but also cost effective.

UNI COLOURS

A05.0.0 Pure White	A04.0.0 Cream White	A05.1.0 Papyrus White	A05.1.1 Stone Beige	A08.2.1 Mid Beige	A08.3.1 Stone Grey	A06.7.1 Natural Greige	A08.8.1 Dark Brown
A03.0.0 White	A04.0.1 Pearl Yellow	A07.1.1 Sand	A08.2.3 Salmon	A10.3.4 Terra Cotta	A11.4.4 English Red	A10.4.5 Sienna Brown	A14.7.2 Deep Red Brown
A03.1.0 Pastel Grey	A04.0.2 Pale Yellow	A05.1.2 Champagne	A05.1.4 Sun Yellow	A06.3.5 Ochre	A08.4.5 Rusty Red	A09.6.4 Mahogany Red	A12.6.3 Wine Red
A35.4.0 Cactus Green	A37.2.3 Spring Green	A41.0.6 Mojito Green	A04.0.5 Zinc Yellow	A04.1.7 Gold Yellow	A10.1.8 Red Orange	A12.1.8 Passion Red	A12.3.7 Carmine Red
A33.3.6 Brilliant Green	A36.3.5 Turf Green	A37.0.8 Lime Green	A32.2.1 Translucent Green	A21.1.0 Winter Grey	A24.4.1 Steel Blue	A20.5.2 Lavender Blue	A17.3.5 Cyclam
A34.8.1 Forest Green	A32.7.2 Dark Green	A30.3.2 Verdigris	A22.2.1 Bluish Grey	A28.6.2 Mid Green	A26.5.4 Pacific	A22.4.4 Brilliant Blue	A20.2.3 Light Viola
A25.8.1 Anthracite Grey	A21.7.0 Steel Grey	A28.2.1 Aquamarine	A22.3.1 Ocean Grey	A22.2.4 Powder Blue	A22.1.6 Royal Blue	A21.5.4 Cobalt Blue	A22.6.2 Dark Denim
A11.8.0 Ceramic Greige	A05.5.0 Quartz Grey	A21.5.1 Mid Grey	A03.4.0 Silver Grey	A24.0.3 Polar Blue	A23.0.4 Mineral Blue	A20.7.2 Dark Blue	A90.0.0 Black
A06.5.1 Toscana Greige	A10.6.1 Taupe	A16.5.1 Mauve					

PROJECT COLOURS



COLOUR YOUR IMAGINATION

Trespa® Meteon® architectural panels are available in a wide choice of standard colours and effects. To create façades that are even more individual and expressive, Trespa® Meteon® panels can be custom-made in special project colours. For more information please contact your local Trespa representative.

METALLICS

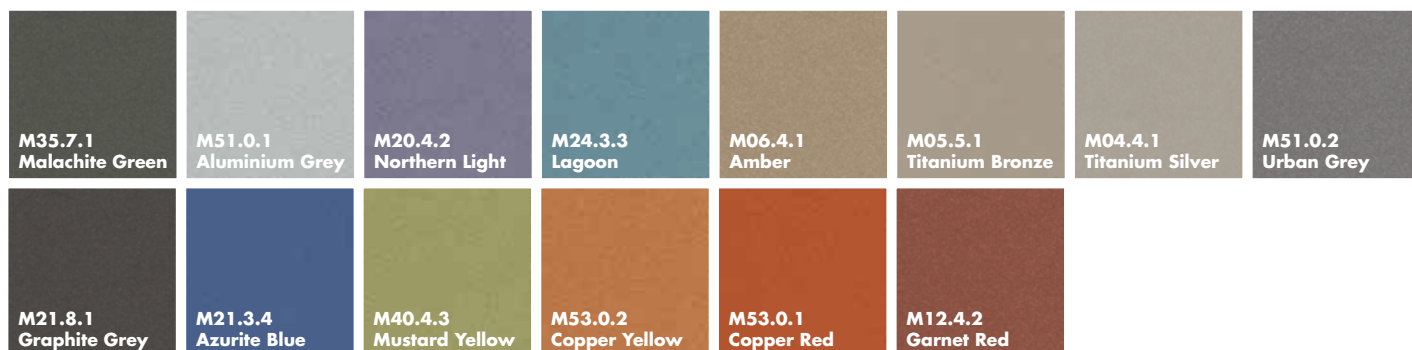

Trespa® Meteor® Metallics panels feature a directional coloured surface.

WOOD DECORS

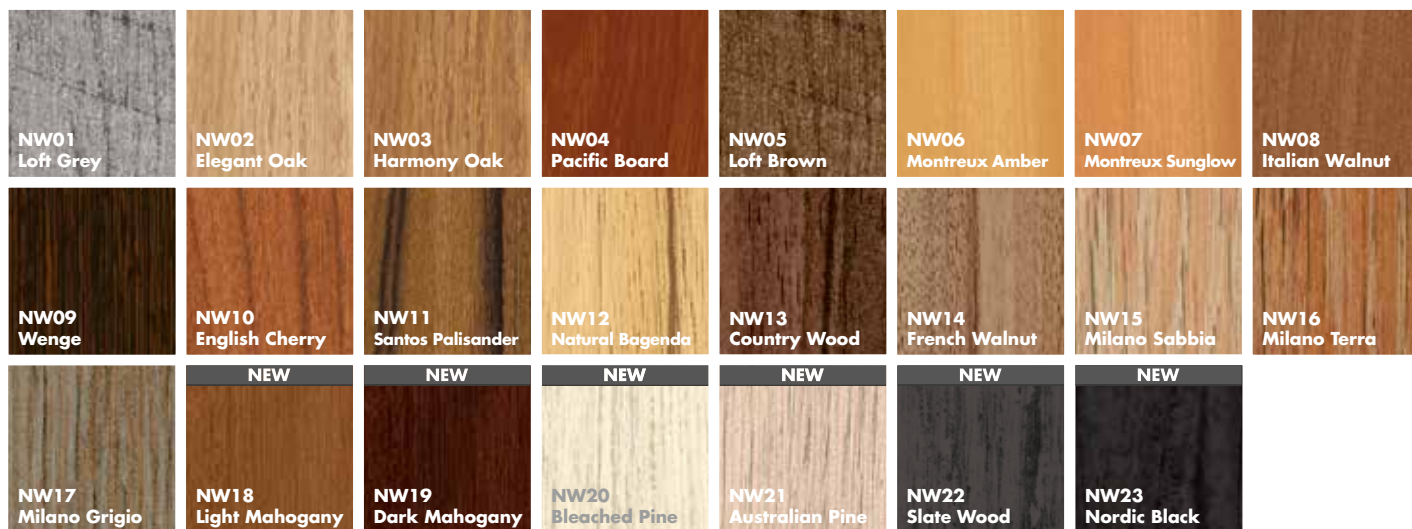

Trespa® Meteor® Wood Decors panels feature a directional coloured surface. The grain of Trespa® Meteor® Wood Decors runs the length direction of the panel.

NATURALS

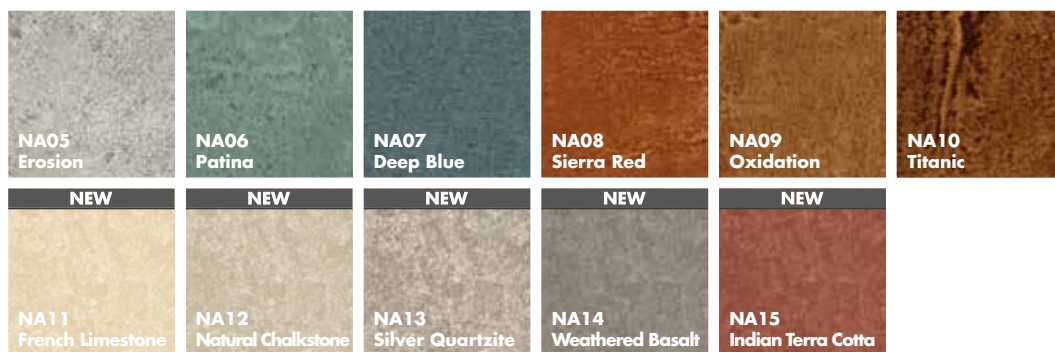

Trespa® Meteor® Naturals panels feature a directional coloured surface.

SIZES

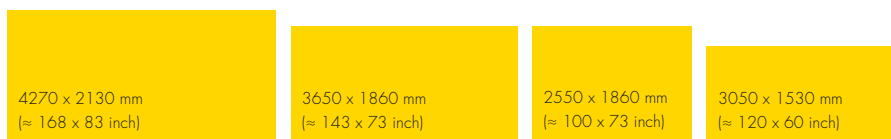

The large size of this panel allows an efficient machining of the product.

Note: Full size panels feature a squareness tolerance. Please check trespa.info for the detailed and up to date Delivery Programme and Material Property Datasheet.

THICKNESSES

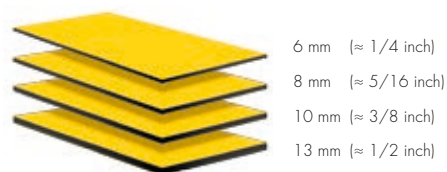

UNI COLOURS

Colour code	Colour name	Satin				Rock		Gloss
A03.0.0	White	■	■	■	■	■	■	■
A03.1.0	Pastel Grey	■	■	■	■	■	■	
A03.4.0	Silver Grey	■	■	■	■	■	■	
A04.0.0	Cream White	■	■	■	■	■	■	
A04.0.1	Pearl Yellow	■	■	■	■	■	■	
A04.0.2	Pale Yellow	■	■	■	■	■	■	
A04.0.5	Zinc Yellow	■	■	■	■	■	■	
A04.1.7	Gold Yellow	■	■	■	■	■	■	
A05.0.0	Pure White	■	■	■	■	■	■	■
A05.1.0	Papyrus White	■	■	■	■	■	■	
A05.1.1	Stone Beige	■	■	■	■	■	■	
A05.1.2	Champagne	■	■	■	■	■	■	
A05.1.4	Sun Yellow	■	■	■	■	■	■	
A05.5.0	Quartz Grey	■	■	■	■	■	■	
A06.3.5	Ochre	■	■	■	■	■	■	
A06.5.1	Toscana Greige	■	■	■	■	■	■	
A06.7.1	Natural Greige	■	■	■	■	■	■	
A07.1.1	Sand	■	■	■	■	■	■	
A08.2.1	Mid Beige	■	■	■	■	■	■	
A08.2.3	Salmon	■	■	■	■	■	■	
A08.3.1	Stone Grey	■	■	■	■	■	■	
A08.4.5	Rusty Red	■	■	■	■	■	■	
A08.8.1	Dark Brown	■	■	■	■	■	■	
A09.6.4	Mahogany Red	■	■	■	■	■	■	
A10.1.8	Red Orange	■	■	■	■	■	■	
A10.3.4	Terra Cotta	■	■	■	■	■	■	
A10.4.5	Sienna Brown	■	■	■	■	■	■	
A10.6.1	Taupe	■	■	■	■	■	■	
A11.4.4	English Red	■	■	■	■	■	■	
A11.8.0	Ceramic Greige	■	■	■	■	■	■	
A12.1.8	Passion Red	■	■	■	■	■	■	
A12.3.7	Carmin Red	■	■	■	■	■	■	
A12.6.3	Wine Red	■	■	■	■	■	■	■
A14.7.2	Deep Red Brown	■	■	■	■	■	■	
A16.5.1	Mauve	■	■	■	■	■	■	
A17.3.5	Cyclam	■	■	■	■	■	■	
A20.2.3	Light Viola	■	■	■	■	■	■	
A20.5.2	Lavender Blue	■	■	■	■	■	■	
A20.7.2	Dark Blue	■	■	■	■	■	■	
A21.1.0	Winter Grey	■	■	■	■	■	■	
A21.5.1	Mid Grey	■	■	■	■	■	■	■
A21.5.4	Cobalt Blue	■	■	■	■	■	■	
A21.7.0	Steel Grey	■	■	■	■	■	■	
A22.1.6	Royal Blue	■	■	■	■	■	■	
A22.2.1	Bluish Grey	■	■	■	■	■	■	
A22.2.4	Powder Blue	■	■	■	■	■	■	
A22.3.1	Ocean Grey	■	■	■	■	■	■	
A22.4.4	Brilliant Blue	■	■	■	■	■	■	
A22.6.2	Dark Denim	■	■	■	■	■	■	
A23.0.4	Mineral Blue	■	■	■	■	■	■	
A24.0.3	Polar Blue	■	■	■	■	■	■	
A24.4.1	Steel Blue	■	■	■	■	■	■	
A25.8.1	Anthracite Grey	■	■	■	■	■	■	■
A26.5.4	Pacific	■	■	■	■	■	■	
A28.2.1	Aquamarine	■	■	■	■	■	■	
A28.6.2	Mid Green	■	■	■	■	■	■	
A30.3.2	Verdigris	■	■	■	■	■	■	
A32.2.1	Translucent Green	■	■	■	■	■	■	
A32.7.2	Dark Green	■	■	■	■	■	■	
A33.3.6	Brilliant Green	■	■	■	■	■	■	
A34.8.1	Forest Green	■	■	■	■	■	■	
A35.4.0	Cactus Green	■	■	■	■	■	■	
A36.3.5	Turf Green	■	■	■	■	■	■	
A37.0.8	Lime Green	■	■	■	■	■	■	
A37.2.3	Spring Green	■	■	■	■	■	■	
A41.0.6	Majito Green	■	■	■	■	■	■	
A90.0.0	Black	■	■	■	■	■	■	■

For available sheet sizes and thicknesses for the above finishes, please check trespa.info for the detailed and up to date Delivery Programme and Material Property Datasheet. Alternatively you can use the Product Selector on trespa.com (after choosing the country where the project is located).

METALLICS

Colour code	Colour name	Satin				Rock		Gloss
M04.4.1	Titanium Silver	■	■	■	■	■	■	
M05.5.1	Titanium Bronze	■	■	■	■	■	■	
M06.4.1	Amber	■	■	■	■	■	■	
M12.4.2	Garnet Red	■	■	■	■	■	■	
M20.4.2	Northern Light	■	■	■	■	■	■	
M21.3.4	Azurite Blue	■	■	■	■	■	■	
M21.8.1	Graphite Grey	■	■	■	■	■	■	■
M24.3.3	Lagoon	■	■	■	■	■	■	
M35.7.1	Malachite Green	■	■	■	■	■	■	
M40.4.3	Mustard Yellow	■	■	■	■	■	■	
M51.0.1	Aluminium Grey	■	■	■	■	■	■	■
M51.0.2	Urban Grey	■	■	■	■	■	■	
M53.0.1	Copper Red	■	■	■	■	■	■	
M53.0.2	Copper Yellow	■	■	■	■	■	■	

WOOD DECORS

Colour code	Colour name	Satin		Matt	
NW01	Loft Grey	■	■	■	■
NW02	Elegant Oak	■	■	■	■
NW03	Harmony Oak	■	■		
NW04	Pacific Board	■	■	■	■
NW05	Loft Brown	■	■	■	■
NW06	Montreux Amber	■	■		
NW07	Montreux Sunglow	■	■		
NW08	Italian Walnut	■	■	■	■
NW09	Wenge	■	■	■	■
NW10	English Cherry	■	■		
NW11	Santos Palisander	■	■		
NW12	Natural Bagenda	■	■		
NW13	Country Wood	■	■		
NW14	French Walnut	■	■	■	■
NW15	Milano Sabbia	■	■		
NW16	Milano Terra	■	■	■	■
NW17	Milano Grigio	■	■	■	■
NW18	Light Mahogany	■	■		
NW19	Dark Mahogany	■	■		
NW20	Bleached Pine	■	■	■	■
NW21	Australian Pine	■	■	■	■
NW22	Slate Wood	■	■	■	■
NW23	Nordic Black	■	■	■	■

NATURALS

Colour code	Colour name	Matt	
NA05	Erosion	■	■
NA06	Patina	■	■
NA07	Deep Blue	■	■
NA08	Sierra Red	■	■
NA09	Oxidation	■	■
NA10	Titanic	■	■
NA11	French Limestone	■	■
NA12	Natural Chalkstone	■	■
NA13	Silver Quartzite	■	■
NA14	Weathered Basalt	■	■
NA15	Indian Terra Cotta	■	■

FINISHES



TYPES

- SINGLE SIDED DECORATIVE: decorative side with non decorative black reverse
- DOUBLE SIDED DECORATIVE: same colour for front and reverse side of the panel
- VARITOP: decorative side with standard white decorative Satin reverse (A03.0.0)
- DUOCOLOUR: different colour for front and reverse side of the panel

CONTACT US

TRESPA INTERNATIONAL B.V.

P.O. Box 110, 6000 AC Weert
Wetering 20, 6002 SM Weert
The Netherlands
www.trespa.com

CUSTOMER SERVICE DESK EMEA EXPORT

Tel: +31 (0) 495 458 359
Fax: +31 (0) 495 458 383
Info.Export@Trespa.com

TRESPA UK LTD.

35 Calthorpe Road
Edgbaston
Birmingham, B15 1TS
United Kingdom
Tel: 0808-2340268
Fax: 0808-2341377
Info.UK@Trespa.com

TRESPA NORTH AMERICA LTD.

62 Greene Street (Ground Floor)
New York, NY 10012
United States of America
Tel: +1 800 487 3772
Fax: +1 866 298 3499
Info.NorthAmerica@Trespa.com

TRESPA CHINA CO. LTD.

Room 2604-05, HuaiHai Plaza
No. 1045 HuaiHai Road (central)
ShangHai 200031
P.R. China
Tel: +86 (0) 21 6288 1299
Fax: +86 (0) 21 6288 1296
Info.China@Trespa.com

CUSTOMER SERVICE DESK ASIA/PACIFIC

Tel: +86 (0) 21 5465 8388
Fax: +86 (0) 21 5465 6989
Info.APAC@Trespa.com

VISIT US

TRESPA DESIGN CENTRE NEW YORK

62 Greene Street (Ground Floor)
New York, NY 10012
United States of America
Tel: +1 212 334 6888
Fax: +1 866 298 3499
TDC.NewYork@Trespa.com
www.trespa.com/tdc

TRESPA DESIGN CENTRE WEERT

Wetering 20
6002 SM Weert
The Netherlands
Tel: +31 (0) 495 458 845
TDC.Weert@Trespa.com
www.trespa.com/tdc

TRESPA DESIGN CENTRE BARCELONA

Calle Ribera 5,
08003 Barcelona
Spain
Tel: +34 (0) 93 295 4193
Fax: +34 (0) 93 116 3300
TDC.Barcelona@Trespa.com
www.trespa.com/tdc

TRESPA DESIGN CENTRE SANTIAGO

Eliodoro Yáñez 2831
Torre A - Local 1
Providencia, Santiago
Chile
Tel: +56 2 4069990
TDC.Santiago@Trespa.com
www.trespa.com/tdc

FOLLOW US



DISCLAIMER

GENERAL

These terms apply to the use of this document and such use automatically means that the other party agrees to these terms. The information provided by Trespa International B.V. ("Trespa") in this document is solely indicative. Trespa is unable to warrant the accuracy and completeness of this information. Trespa may change the information included in this document at any time and without further notice. Trespa's customers and third parties must ascertain that they have the most recent document (for the most recent version, please consult: www.trespa.com). No rights can be derived from the information provided; the use of the information is at the other party's risk and responsibility. Trespa does not warrant that the information in this document is suitable for the purpose for which it is consulted by the other party. This document does not contain any design, structural calculation, estimate or other warranty or representation that customers and third parties may rely on. This document does not guarantee any properties of Trespa products. Colours used in Trespa's communications (including but not limited to printed matter) and in samples of Trespa's products may differ from the colours of the Trespa products to be supplied. Samples are not intended for use in product tests and are not representative of characteristics of the Trespa

products. Trespa's products and samples are produced within the specified colour tolerances and the colours (of production batches) may differ, even if the same colour is used. The viewing angle also influences the colour perception. Metallics panels feature a surface whose colour appears to change based on the direction from which it is viewed. The specified colour stability and colour specifications relate only to the decorative surface of the Trespa products, not to the core material and samples of the Trespa products. Trespa products are delivered ex-works with straight, sawn sides. Customers and third parties must have a professional adviser inform them about (the suitability of) the Trespa products for all desired applications and about applicable laws and regulations. Trespa does not warrant the above. The most recent version of the current delivery programme and the Material Properties Datasheet can be found at www.trespa.info. Only the information in the most recent and valid Material Properties Datasheet should be used to select and provide advice regarding Trespa products. Trespa reserves the right to change (the specifications for) its products without prior notice.

LIABILITY

Trespa is not liable (neither contractual nor non-contractual) for any damage arising from or

related to the use of this document, except if and to the extent that such damage is the result of wilful misconduct or gross negligence on the part of Trespa and/or its management. The limitation of liability applies to all parties affiliated with Trespa, including but not limited to its officers, directors, employees, affiliated enterprises, suppliers, distributors, agents, and representatives.

GENERAL CONDITIONS

All oral and written statements, offers, quotations, sales, supplies, deliveries and/or agreements and all related activities of Trespa are governed by the Trespa General Terms and Conditions of Sale (*Algemene verkoopvoorwaarden Trespa International B.V.*) filed with the Chamber of Commerce and Industry for Noord- en Midden-Limburg in Venlo (NL) on 11 April 2007 under number 24270677, which can be found on and downloaded from the Trespa website, www.trespa.com/documentation. All oral and written statements, offers, quotations, sales, supplies, deliveries and/or agreements and all related work of Trespa North America, Ltd. are governed by the Trespa North America General Terms and Conditions of Sale, which can be found on and downloaded from the Trespa website, www.trespa.com/documentation. A copy of these general conditions of sale will be provided free of

charge on request. All general terms and conditions other than the conditions mentioned above are dismissed and do not apply, regardless of whether such terms and conditions are referred to on requests for offers, offer confirmations, stationery and/or other documents of the other party, even if Trespa does not expressly object to such terms and conditions.

INTELLECTUAL PROPERTY

All intellectual property rights and other rights regarding the content of this document (including logos, text and photographs) are owned by Trespa and/or its licensors. Any use of the content of this document, including distribution, reproduction, disclosure, storage in an automated data file or the dispatch of such a file without Trespa's prior written consent is explicitly prohibited. * Trespa, Meteon, Athlon, TopLab, TopLab^{PLUS}, TopLab^{ECO-FIBRE}, Virtuon, Izeon, Volkern, Trespa Essentials and Mystic Metallics are registered trademarks of Trespa.

QUESTIONS

Should you have any questions or comments, please do not hesitate to contact Trespa.

VERSION 3.0 ■ BROCHURE CODE U2405 ■ DATE 08-2014



VISIT TRESPA.COM FOR THE MOST
UP TO DATE VERSION OF THIS DOCUMENT.

TRESPA®